

1. Bauabschnitt
BBGZ

2. Bauabschnitt
Ideenteil

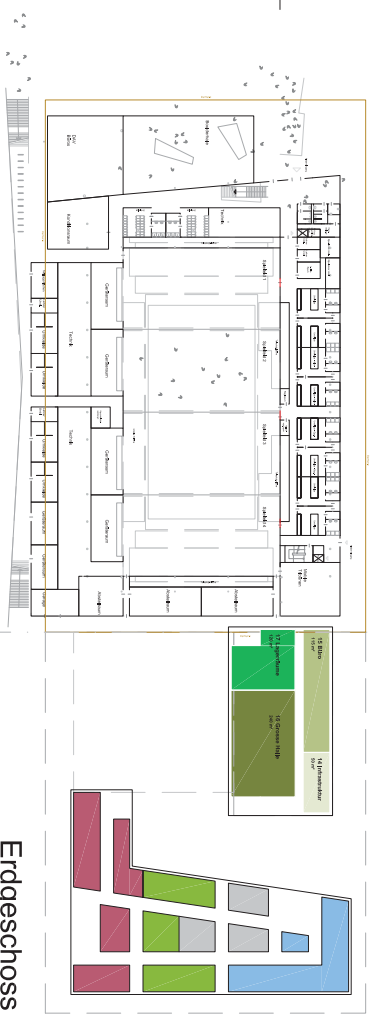

Erdgeschoss

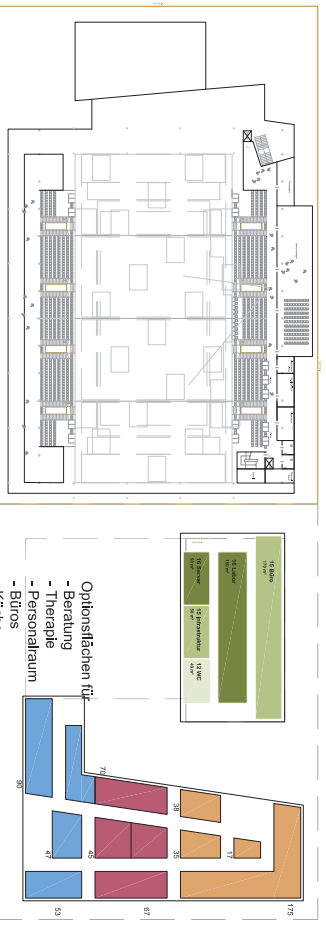

2. Obergeschoss

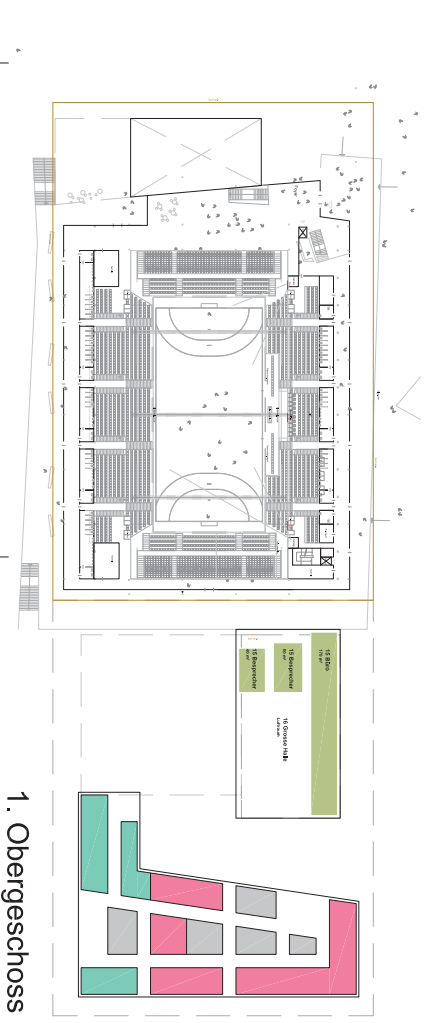

1. Obergeschoss

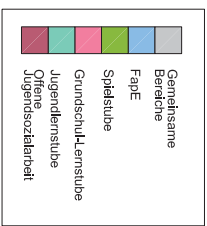

**NEUBAU
BÜRGER-, BEGEGNUNGS-
UND
GESUNDHEITZENTRUM
IN ERLANGEN**

Vorplanung
Ideenteil -
M 1:500
28.01.2015